

# Building Sketch

Borrower/Client	N/A			
Property Address	3016 Synnotts Pl			
City	Durham	County	State	NC
Lender			Zip Code	27705

**8 RM / 4 BR / 2 FB / 1 HB**  
**Finished Area: 1,959 sf**

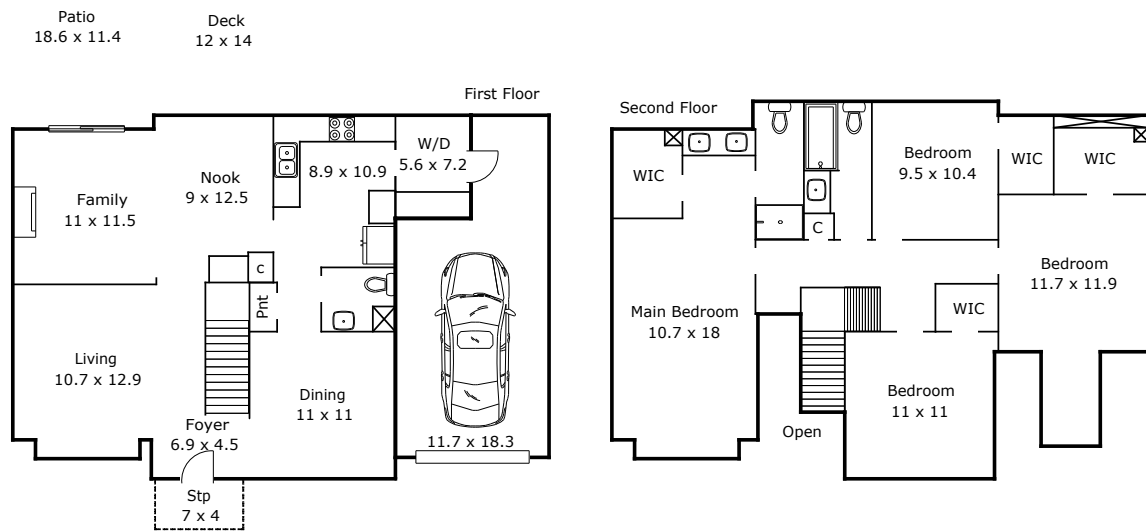

TOTAL Sketch by a la mode

### Area Calculations Summary

<b>Living Area</b>	
First Floor	893.79 Sq ft
Second Floor	1065.7 Sq ft
<b>Total Living Area (Rounded):</b>	<b>1959 Sq ft</b>
<b>Non-living Area</b>	
Stoop	28 Sq ft
1 Car Attached	282.64 Sq ft